

FOR MAKING KEYS Uni 6604 / Din 6885

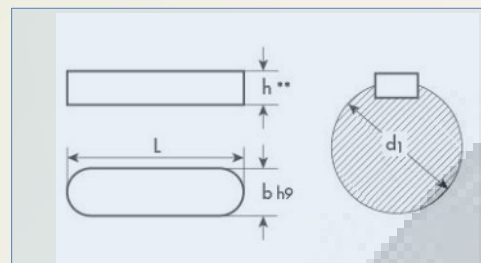

MILLING keys MACHINE

TYPE MC 200/2 CN



TYPE A

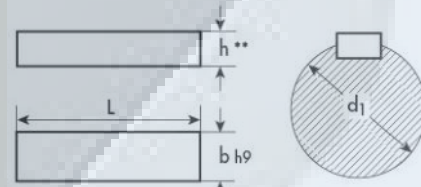

TYPE B

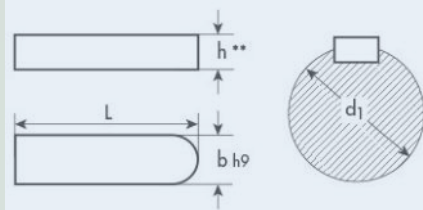

TYPE A / B



HOURLY PRODUCTIVITY CAPACITY

MEASURES B x h x L	PIECES
6 x 6 x 12	1250
8 x 7 x 15	1050
10 x 8 x 15	900
12 x 8 x 15	900
14 x 9 x 20	800
16 x 10 x 20	700
18 x 11 x 20	650
20 x 12 x 20	600

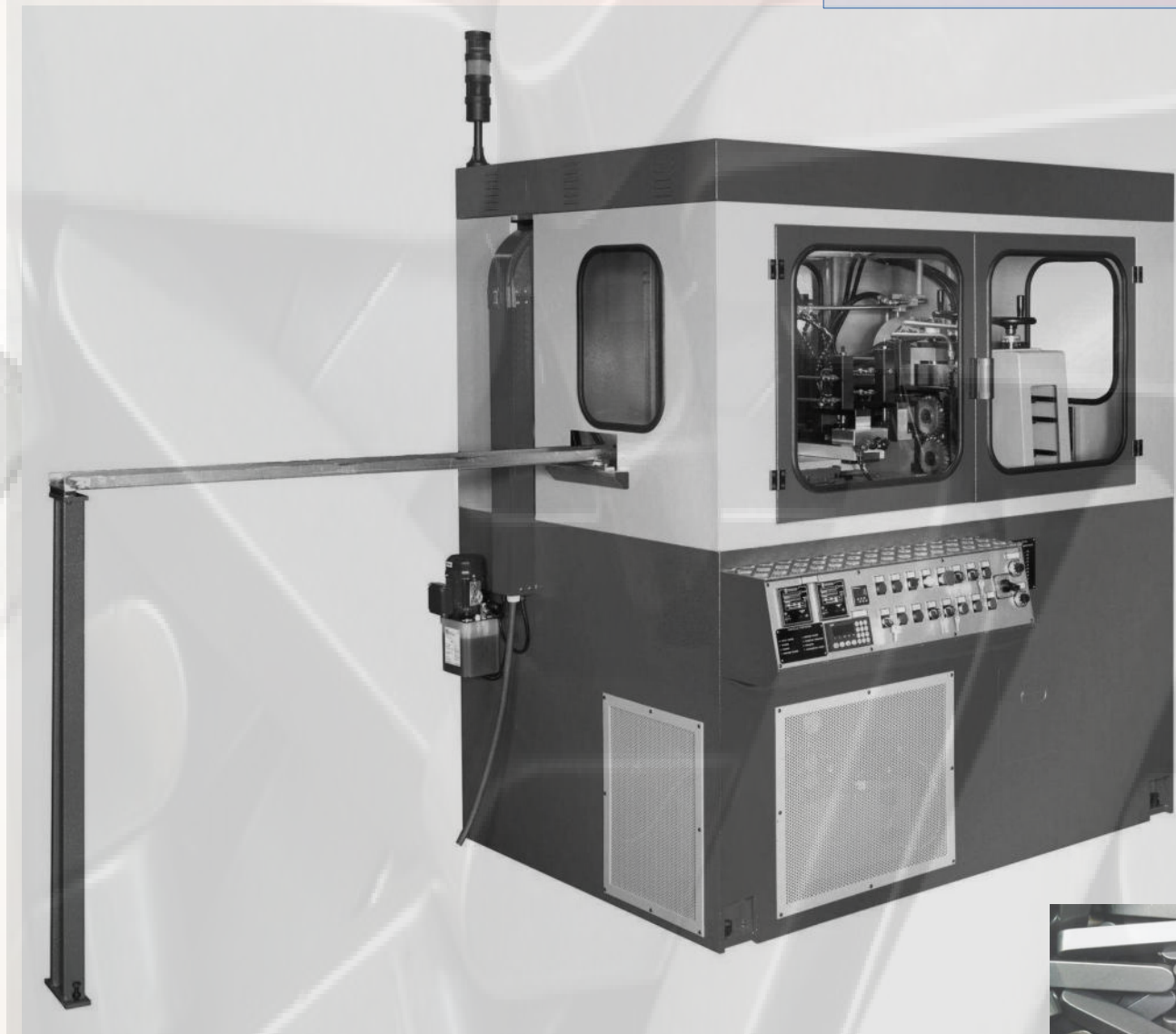

Legal Address : Via Piceni 5, 21013 Gallarate VA
 Operative Headquarters Address : Via Foro San Martino 35, 21012 Cassano Magnago VA
 omvitaliasrl.it info@omvitaliasrl.it ITALY

MC 200 /2 CN

TECHNICAL DESCRIPTION:

Basement is built by a steel structure electro welded. The basement is also, tempering, stabilized, sandblasted and painted with an epoxy backdrop. Final painting is made by blu RAL 7016 colour for the structural parts of the machine. Gray RAL 7035 for the carter and the hydraulic unit. If you prefer we can customize the final painting according your needs.

N°2 Milling/cut head, lubricating gear box supply, it slides on tempered and round rails, with forced and automatic lubrication, and its horizontal movement is driven by no. 1 brushless motor with axle controlled and managed by a suitable drive and ball screw.

N°1 Gear box manual input for the regulating rpm mills from inverter.

N°1 Avanced bars unit, it slides on tempered and round rails, with forced and automatic lubrication, and its horizontal movement is driven by no. 1 brushless motor with axle controlled and managed by a suitable drive and ball screw.

N°1 Hydraulic system embodied in the structure of the machine, provider with distributors, regulators, electric oil gauge to signal oil low level, manometer and filter, in a comfortable position for easy maintenance service.

TECHNICAL DATA

Working capacity: B x H = mm. 6 x 6 - mm. 20 x 12

Length minimum and maximum : mm. 12 – mm 400.

Length of loadable bars: Mt. 6

rpm mill: Manual /Auto regulation from inverter.

N° 2 mill motor: 2,2 Kw.

N° 1mill motor axis: 3,58 Nm

N° 1advanced bar motor axis: 2,39 Nm

Hydraulic pump motor: 1,1 Kw.

Cooling pump motor: 0,37 Kw.

Lubrification guide motor: 0,09 Kw.

Heating exchanger motor: 0,09 Kw.

Installed rated power: 12 Kw.

Supply voltage: V 400 3 Ph 50/60 Hz.

Machine dimensions: 1600 x 1100 x H 1900.

Total weight: 1800 Kg.



N°1 Electric device system embodied in the structure of the machine in a comfortable position for easy maintenance service with components:

- Eletromecanichal parts Siemens.
- All with Profinet System by Siemens:
- Workpiece and drive feed engine motor, Sinamics V90 Profinet
- Cutter and drive feed motor Sinamics V90 Profinet
- Inverter rotary cutters, Sinamics Profinet - Sinamics G 120 panel operator BOP-2
- Operator panel Siemens ;
- N°1 electronic work counter with automatic disconnection of the machine when the set quantity.
- PLC Siemens 1200
- Indicator device end bar.
- Mill-protection device with instantaneous intervention for possible overloads.

N°1 Oil electric pump for the lubricating slides, provider boxes level vision oil, with electric switch to signal oil low level.

N°1 Chip conveyor system embodied in the structure of the machine.

N°1 Cooling mill system with liquid tank embodied in the structure of the machine.

Protections in strong steel structure, with openings equipped with safety micros for the immediate shutdown of the machine in case of fortuitous opening, in compliance with the standards in force

Legal Address : Via Piceni 5, 21013 Gallarate VA
Operative Headquarters Address : Via Foro San Martino 35, 21012 Cassano Magnago VA
omvitaliasrl.it info@omvitaliasrl.it ITALY